

# Care of Equipment - Care of Mops

## Task Card

For best cleaning performance, cotton mops should always complete a break-in period to remove naturally occurring oils before first use. For microfiber mop heads follow separate microfiber chart.

### To break-in a Cotton Mop

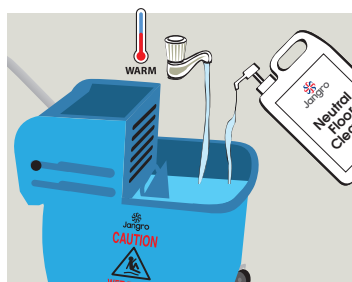

- 1 Fill a mop bucket with water and a diluted neutral floor cleaner according to directions. Water temperature should be warm.

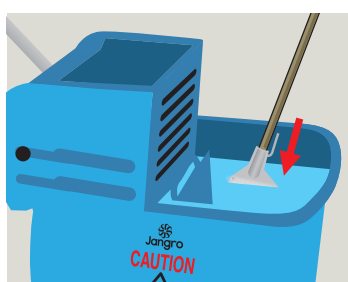

- 2 Immerse the mop head for 5 seconds and agitate, ensuring the solution is absorbed in all mop fibres.

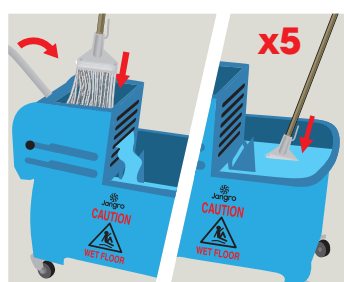

- 3 Wring-out, rinse and repeat the process up to 5 times if necessary.

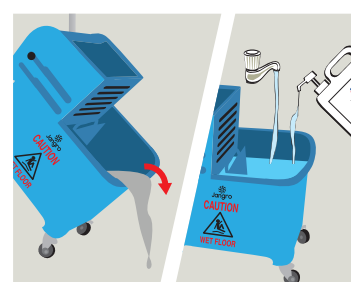

- 4 Dispose of cleaning solution and prepare a fresh solution for the appropriate cleaning tasks.

### Care of Mops



- 1 Remove soiled mop from the handle.

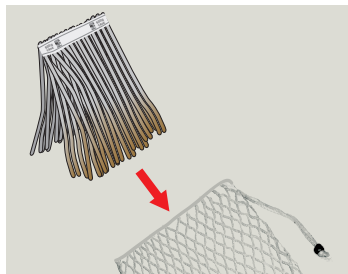

- 2 Wash/laundry the mop head (for laundering cotton mop head, place mop head in a netted bag).

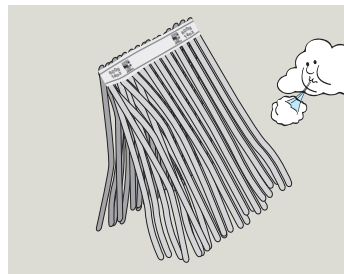

- 3 Allow to air dry in ventilated area.

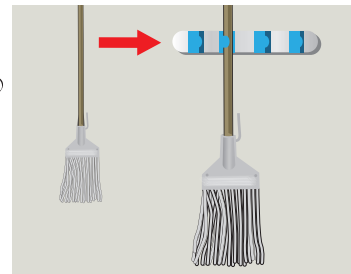

- 4 Store assembled mop in a wall bracket off the ground to allow head to air dry in a ventilated area. If no wall bracket is available store head up without touching walls or floors.

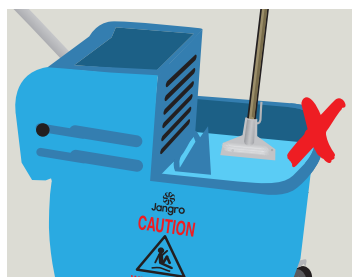

- 5 Never leave mop in water/cleaning solution.

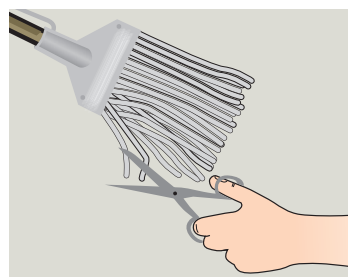

- 6 Cut off any loose strands to prevent snagging and splattering.

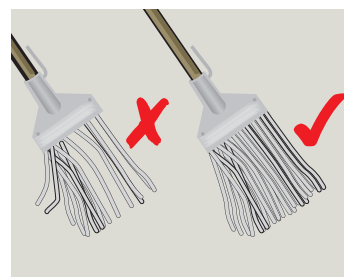

- 7 Discard and replace when worn out. Lost strands decrease the mops ability to perform.

## Care of Dust Mops - Machine Washing

The following procedure for machine washing soiled dust mops will assure maximum dusting results. It may not be appropriate to launder mops of certain fibres &/or within specific environments. Please always check before proceeding.

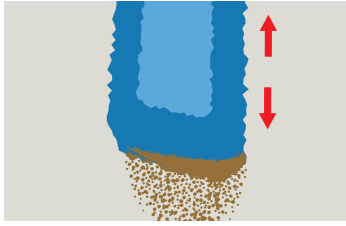

- 1** Briskly shake out or vacuum excessive dust in mop head.

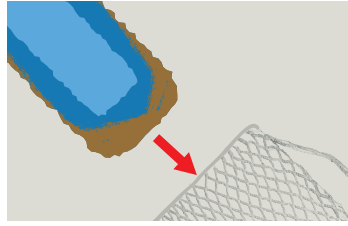

- 2** Place head snugly in net washing bag or other perforated bag.

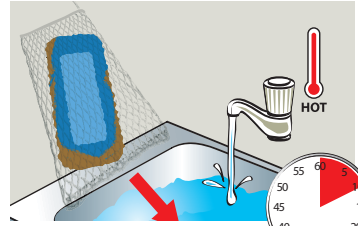

- 3** Soak mop for 10 minutes in hot, soapy water.

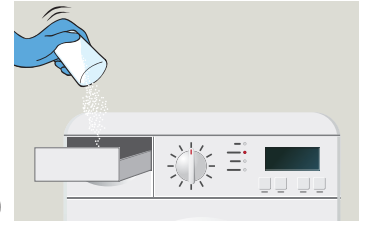

- 4** Pour 1 capful of laundry detergent (unless automatically dosed) into the washing machine. Do not use fabric conditioner. If chemical is auto-dosed, select appropriate program & do not add further detergent.

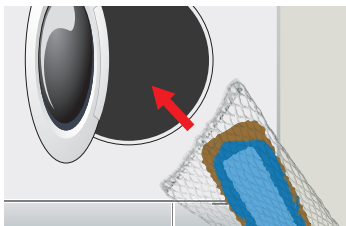

- 5** Insert mop head into machine.

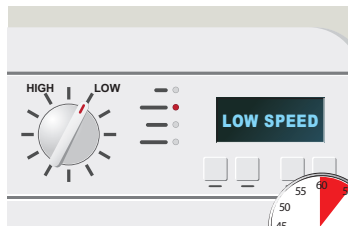

- 6** Wash mop head 3-5 minutes in hot, soapy or detergent water at low machine speed. CAUTION: Never machine wash mop head by itself - always wash in a full machine load. Over-washing or the use of bleach will cause severe damage to the yarn.

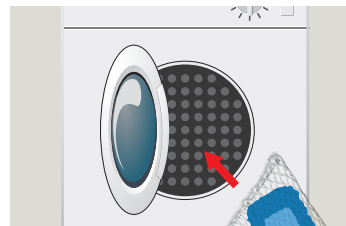

- 7** Tumble dry, not exceeding 180°F until dry. Excessive temperatures and drying times will cause rapid mop deterioration.

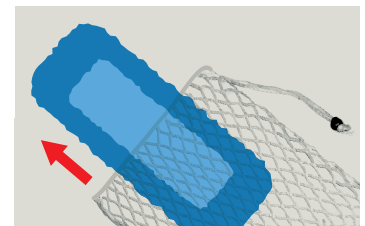

- 8** Remove head from washing bag.

## Care of Dust Mops - Hand Washing

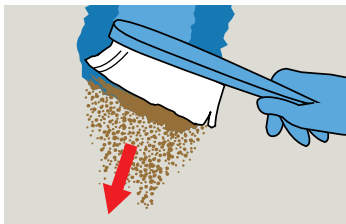

- 1** Vacuum or use a counter dusting brush to remove as much visible soil as possible.



- 2** Dilute 25 - 35 ml of Fabrix Laundry Detergent in a bucket with 5 litres of warm water.

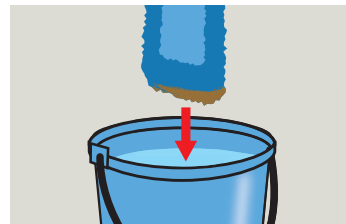

- 3** Place the soiled mop into the solution and leave to soak.

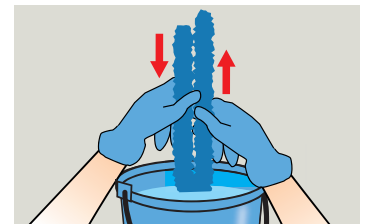

- 4** Rub the dust mop together vigorously in the solution to remove soiling.

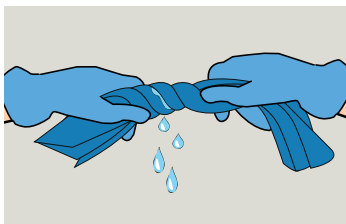

- 5** Once you have removed as much soil as possible, wring out the dust mop.

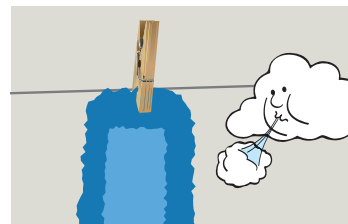

- 5** Once satisfied you have extracted the excess water, simply hang the dust mop up and allow to air dry.

On average, the dust mop should be dry in 2-4 hours, cotton dust mops retain the greatest amount of moisture where synthetics mops don't.