

How to Clean Basins & Taps

Task Card

Guide to remove dirt and limescale from basins and taps to leave them clean and sparkling.

Equipment Required



- 1** Safety Signs.
PPE - Gloves.
Plus any additional
PPE specific to the
Cleaning Solution.

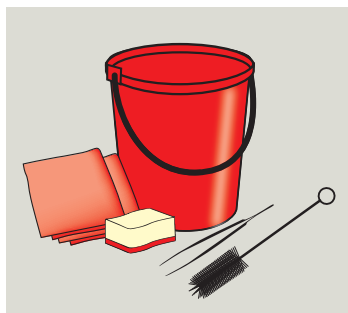

- 2** Bucket (Colour coded).
Cleaning cloths.
Non-abrasive pad.
Tweezers.
Bottle brush.



- 3** Cleaning Solution.
Stainless Safe Descaler.

Preparation



- 1** Place safety signs.

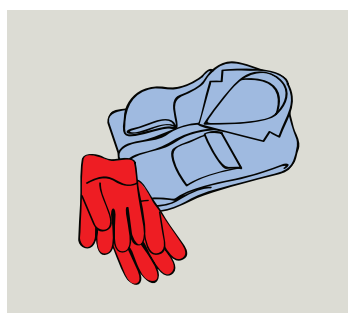

- 2** Wear appropriate PPE.

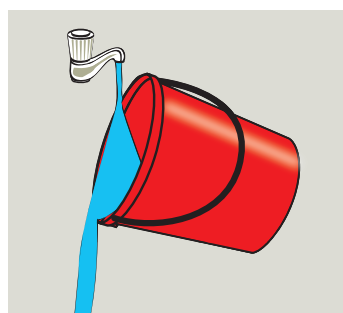

- 3** Check bucket is clean
and ready to use. If dirty,
rinse out with clean
water.



- 4** Fill bucket half way with
water.



- 5** Add cleaning solution to
the water according to
directions on the label.
(Note: Always add chemical to
water, not the other way round as
to avoid chemical splashing).

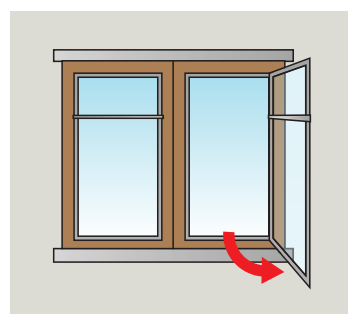

- 6** If possible, ventilate the
room. i.e. open windows.

Cleaning the Wash Basin & Taps

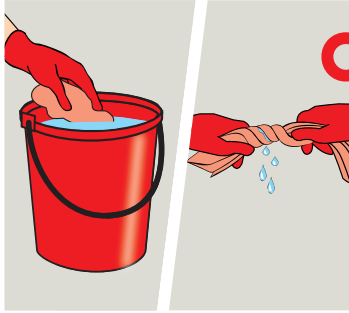

OR



1 Use a colour coded cloth wrung out in cleaning solution.

2 Spray solution onto a cloth from a trigger bottle.

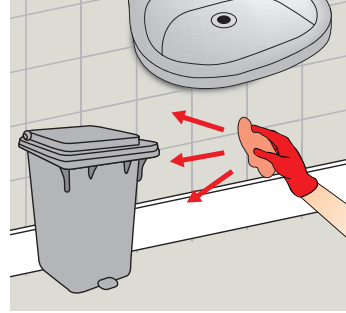

3 Wipe surrounding surfaces including wall tiles, ledges, pipes, waste bin and underneath the basin.



4 Remove any objects from the basin e.g. soap.

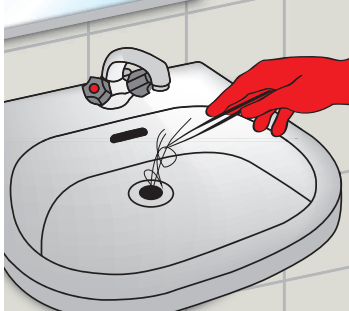

5 Remove any loose hair or other items from the plug, chain and plug hole with tweezers.

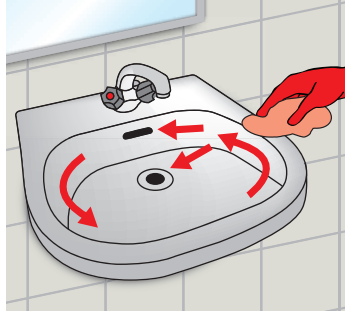

6 Using a colour coded cloth rinsing out in cleaning solution, wipe around the inside of the basin, including plug, chain, taps and overflow.

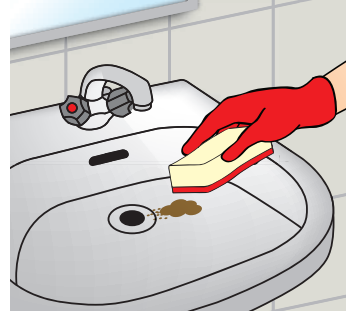

7 Scrub stubborn stains with a non-abrasive scourer.



8 Use a stainless steel safe, chemical descaler to remove any build-up of limescale on the taps.
Follow manufactures instructions to ensure no damage is caused.



9 With running tap water, rinse the basin area thoroughly, swilling water into the overflow.

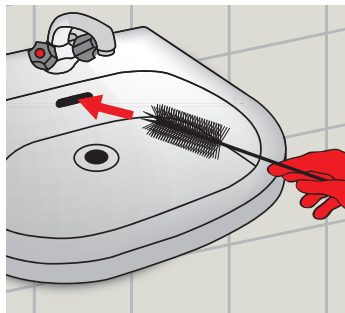

10 Clean the overflow with the bottle brush.



11 Wring out the cloth and polish any stainless steel or chrome.



12 Replace all items.

Final Stages



1 Discard dirty water from the bucket.

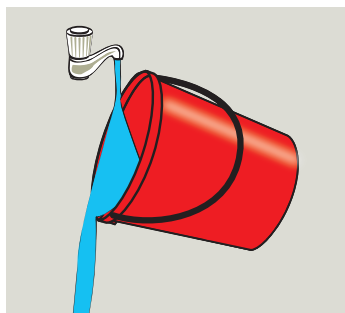

2 Clean and dry the bucket.



3 Dispose/Laundrer the cloth.



4 Remove safety signs when area is dry and clear of trip hazards.