

When dosing concentrate chemicals always use the recommended PPE, and always read the labels to check best practice for handling both the undiluted & ready to use solutions.

# Product Usage Guide

PREMIUM

## BC065-5



### Health & Safety

Please refer to relevant COSHH Safety Data Sheet



Scan for further product details

### Mopping



**1** Use appropriate PPE as indicated in the Safety Data Sheet and place Safety Signs.



**2** Dilute product 1:1 part water for severe odours or 1:20 parts water for general maintenance.

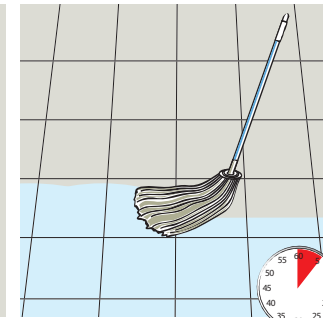

**3** Mop contaminated surfaces, working well into the soiling with a clean, damp mop. Leave for 5 minutes.

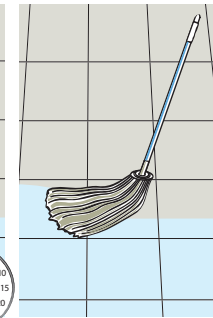

**4** Mop away excess then leave to air dry.



**5** Remove Safety Signs.

### Spraying



**1** Use appropriate PPE as indicated in the Safety Data Sheet and place Safety Signs.



**2** Dilute product 1:1 part water for severe odours or 1:20 parts water for general maintenance.

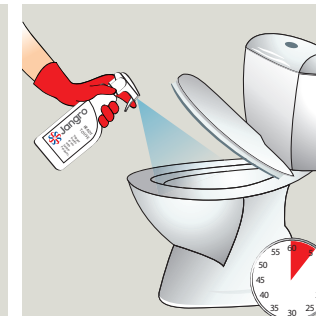

**3** Spray contaminated surfaces, working well into the soiling with a clean, damp cloth. Leave for 5 minutes.



**4** Wipe away excess then leave to air dry.



**5** Remove Safety Signs.



Do not store diluted product.