

Foaming Bactericidal Cleaner



When dosing concentrate chemicals always use the recommended PPE, and always read the labels to check best practice for handling both the undiluted & ready to use solutions.

Product Usage Guide

Professional



BC010-5



General Cleaning



1 Use appropriate PPE as indicated in the Safety Data Sheet.

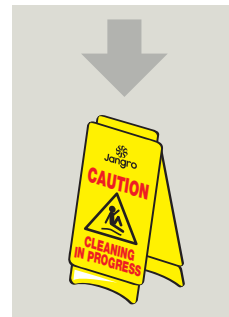

2 Place Safety Signs.

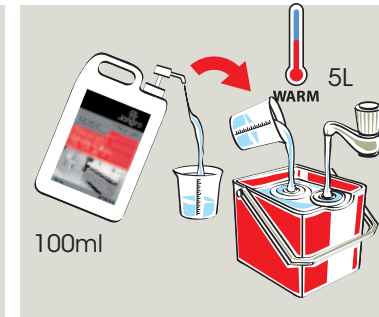

3 Dilute 100ml per 5 litres of warm water.



4 Mop or wipe surface.



5 Once surface is dry remove Safety Signs.

Baths and Showers



1 Use appropriate PPE as indicated in the Safety Data Sheet.

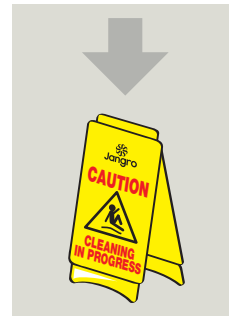

2 Place Safety Signs.



3 Pour undiluted solution into bottle fitted with foaming spray.

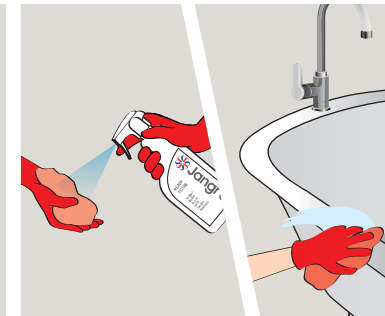

4 Spray cloth and wipe clean surface.



5 Once surface is dry remove Safety Signs.

Health & Safety

Please refer to relevant COSHH Safety Data Sheet



Scan for further product details



Not for use on cast iron enamelled baths, marble or limestone.

www.jangro.net